

# Nylon-Like ESD

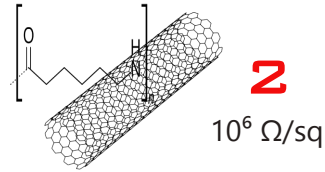

| TECHNICAL DATA SHEET                            |                            |             |
|---|----------------------------|-------------|
|   | Cure >20 min.              | Standards   |
| After a first use, we recommend 6 months of use |                            |             |
| Color   | Black                      |             |
| Wavelength (nm)                                 | 395-405                    |             |
| Density (g/cm <sup>3</sup> )                    | 1.15                       |             |
| Flexure strength (MPa)                          | 33                         | ISO 178     |
| Flexure modulus (MPa)                           | 1050                       | ISO 178     |
| Tensile strength (MPa)                          | 36                         | ASTDM D638  |
| Tensile modulus (MPa)                           | 1300                       | ASTDM D638  |
| Strain at break (%)                             | 13                         | ASTDM D638  |
| Hardness (Shore D)                              | 74                         | /           |
| Heat Deflection Temp. (°C)                      | 60                         | ISO 180     |
| Surface resistivity (Ω/sq)                      | 1.17E+06 - 10 <sup>6</sup> | ASTDM D257  |
| Volume resistivity (Ω·cm)                       | 1.33E+06 - 10 <sup>6</sup> | ASTDM D4496 |

Tensile ASTDM D638 - Type V

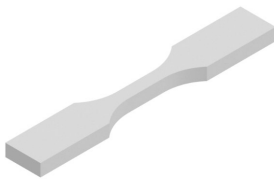

Flexure ISO 178

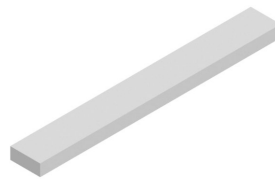

**SAFETY – WARNING**

H302.Harmful if swallowed – H315.Causes skin irritation – H317.May cause an allergic skin reaction – H319.Causes serious eye irritation – H411.Toxic to aquatic life with long lasting effects – P261.Avoid breathing dust/fume/gas/mist/vapours/spray – P264. Wash arms, hands and face thoroughly after handling – P272.Contaminated work clothing should not be allowed out of the workplace – P273.Avoid release to the environment – P280.Wear protective gloves/protective clothing/eye protection/face protection – P305&P351&P338 IF IN EYE: Rinse cautiously with water for several minutes. Remove contact lenses if present and easy to do. Continue rinsing – P302&352 IF ON SKIN: Wash with soap and water – P310.Immediately call a POISON CENTER or doctor/physician  
P501.Dispose of contents and container in accordance with all local, regional, national and International regulations